

Feb 05, 2020 6:48am PLOTTED BY AKuegler SAVED BY AKuegler
 IMAGES: RM SQUARE - Full Color-Print
 G:\CSD_201018119_Village of Fontana\10020 South Lake Shore Drive Reconstruction\Zcp\Detour Plan.dwg

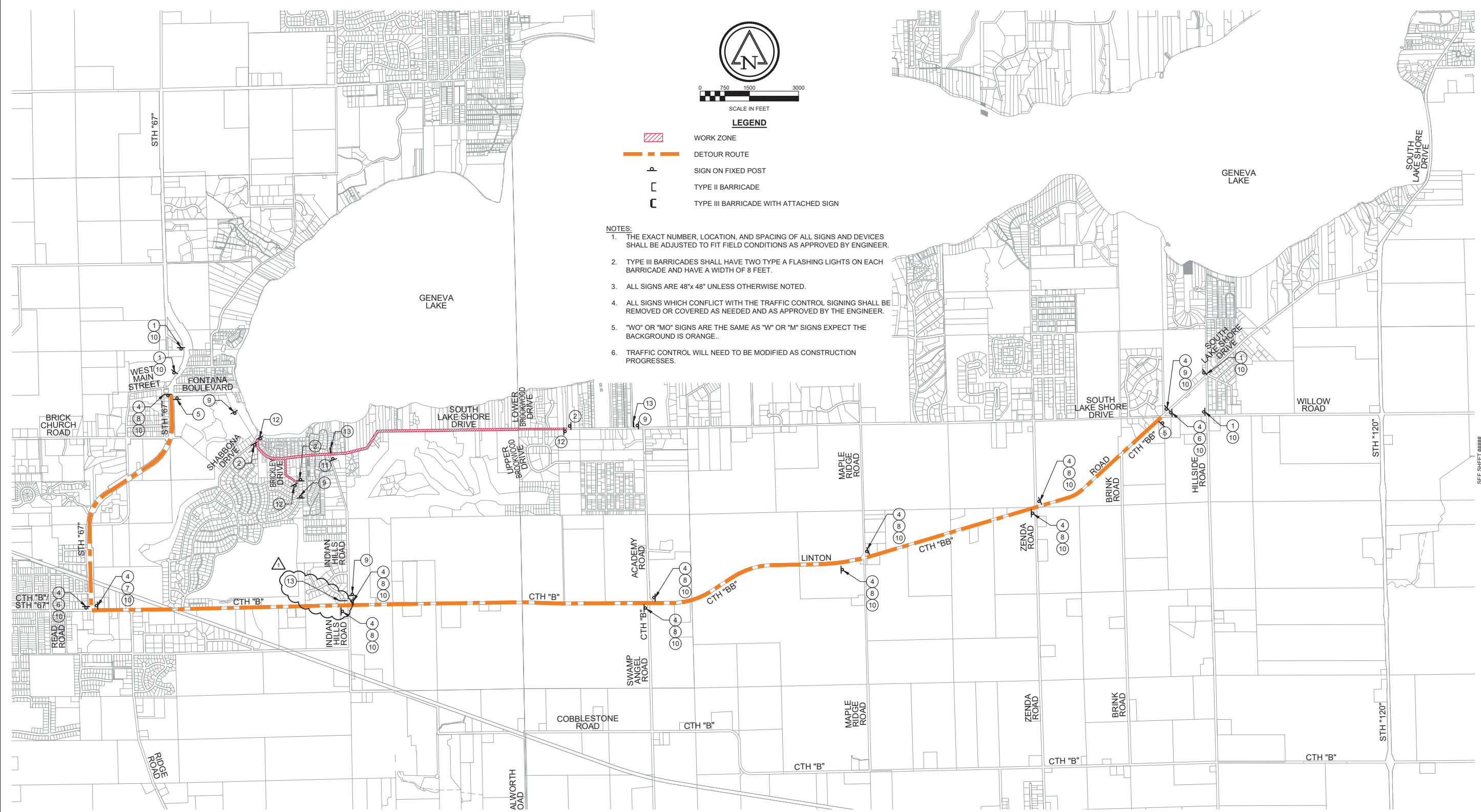

LEGEND

- WORK ZONE
- DETOUR ROUTE
- SIGN ON FIXED POST
- TYPE II BARRICADE
- TYPE III BARRICADE WITH ATTACHED SIGN

- NOTES:**
1. THE EXACT NUMBER, LOCATION, AND SPACING OF ALL SIGNS AND DEVICES SHALL BE ADJUSTED TO FIT FIELD CONDITIONS AS APPROVED BY ENGINEER.
 2. TYPE III BARRICADES SHALL HAVE TWO TYPE A FLASHING LIGHTS ON EACH BARRICADE AND HAVE A WIDTH OF 8 FEET.
 3. ALL SIGNS ARE 48" X 48" UNLESS OTHERWISE NOTED.
 4. ALL SIGNS WHICH CONFLICT WITH THE TRAFFIC CONTROL SIGNING SHALL BE REMOVED OR COVERED AS NEEDED AND AS APPROVED BY THE ENGINEER.
 5. "WO" OR "MO" SIGNS ARE THE SAME AS "W" OR "M" SIGNS EXCEPT THE BACKGROUND IS ORANGE.
 6. TRAFFIC CONTROL WILL NEED TO BE MODIFIED AS CONSTRUCTION PROGRESSES.

1 **W20-2**
2 **ROAD CLOSED TO THRU TRAFFIC**
3 **ROAD CLOSED**
4 **DETOUR**
5 **END DETOUR**
6 **←**
7 **→**
8 **↑**
9 **ROAD CLOSED AHEAD**
10 **SOUTH LAKESHORE DRIVE**
11 **WORK ZONE**
12 **END ROAD WORK**
13 **S. LAKESHORE DRIVE TO CLOSE MESSAGE**
 PORTABLE CHANGEABLE MESSAGE SIGN PHASE 1 (3 SEC.)
13 **FOLLOW DETOUR**
 PORTABLE CHANGEABLE MESSAGE SIGN PHASE 2 (2 SEC.)

SEE SHEET #####

Ruekert • Mielke
 Waukesha • Kenosha • Madison
 Global Water Center • Fox Valley
www.ruekertmielke.com

SOUTH LAKESHORE DRIVE RECONSTRUCTION
DETOUR PLAN
VILLAGE OF FONTANA-ON-GENEVA LAKE
WALWORTH COUNTY, WISCONSIN

© COPYRIGHT 2020 RUEKERT & MIELKE INC.
 DESIGNED BY: TRT
 DRAFTED BY: AK2
 CHECKED BY: RAE
 DATE: JANUARY 2020
 FILE NO.
8119-10020.200

SHEET NO.
TC-01R-1

TOWN: 1N
 RANGE: 16E/17SECTION(S)
 13 NW, 13 NE, 13 SW, 13 SE, 14 SE/16 NW & 16 SW

BID SET